

M2000 Safety Harness Eye Bolt Tester Kit



Model 2000 Medium Duty Fixing Testers - enabling engineers to confirm the holding power of anchors in most construction materials.

The Model 2000 Eye Bolt Kit comprises the necessary accessories to enable the pull test of common Eye bolt and ring bolt fixings.



M2000 Eye bolt kit contents

- Detachable dual scale 25kN digital gauge.
- Load spreading bridge with adjustable telescopic legs and swivel feet.
- Turning Handle with 22mm integrated nut (for use in confined spaces).
- M12 Ringbolt Adaptor Clevis.
- Calibration certificate (valid for 12 months).
- Robust carry case.
- Full operating instructions.



M2000 Safety Harness Eye bolt kit features



Improved load spreading bridge design.



Made in Britain.

Telescopic legs for quick and easy height adjustment.

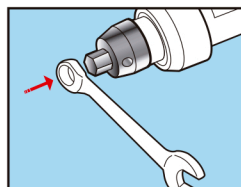
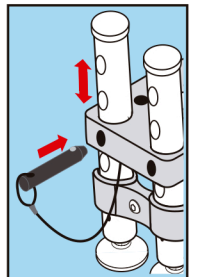

Turning handle design incorporating operating nut and detachable handles allowing use in confined spaces.

M12 Ringbolt Adaptor Clevis



Compatible with the latest Hydrajaws Bluetooth Digital System.*

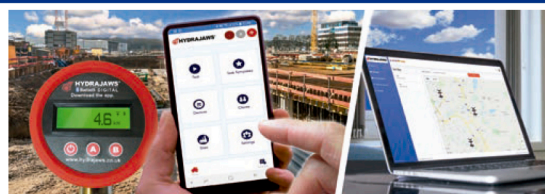

Record results digitally using the Hydrajaws App and manage results and reports from a remote online dashboard

* Requires separate subscription charge. Enquire for details.

For more information contact Hydrajaws Limited or go to www.hydrajaws.co.uk